

REV	ECN NO.	APP.	DATE
A	NEW DESIGN		

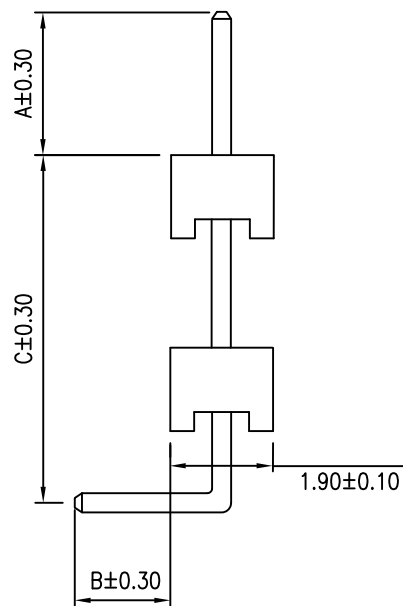
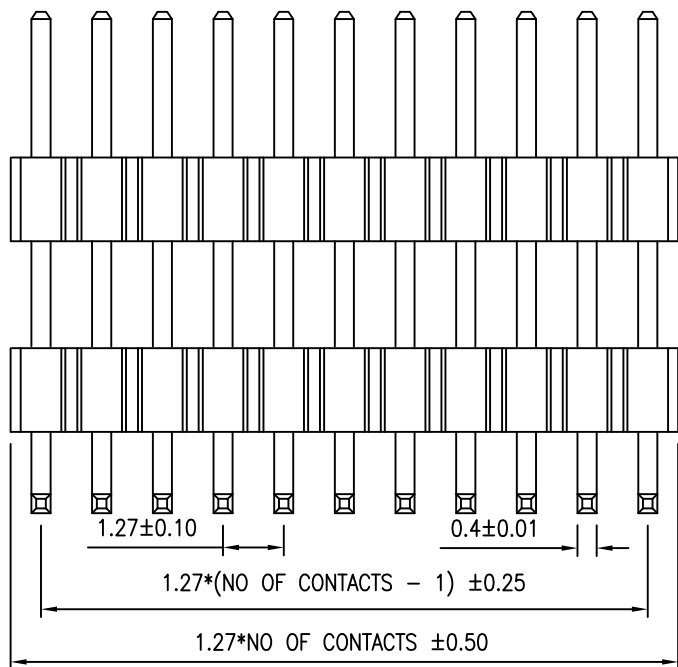

SPECIFICATION

- \* Current Rating: 1 A
- \* Withstanding Voltage: 300 VAC ( 1 min. )
- \* Insulation Resistance: 1000 Megohms MIN.
- \* Contact Resistance: 30 Milliohms MAX.
- \* Operating Temperature:  $-40^{\circ}\text{C}$  to  $+105^{\circ}\text{C}$

ORDER INFORMATION

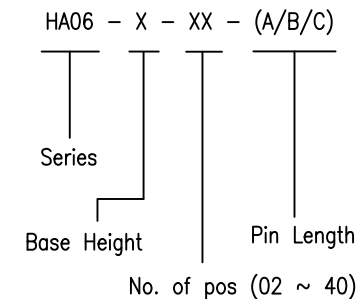

MATERIAL

- \* Contact: Brass  
0.40mm square post
- \* Insulator: PA6T & 30% G.F.
- \* Plating: All Gold

Base Height

Base	H
1	1.00
2	1.50
3	2.00
4	2.50
5	3.00

Pin Chart

Pin	A	B	C
1	2.50	2.00	6.00
2			
3			
4			
5			

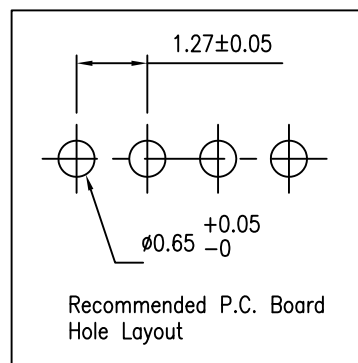

(주)신화테크 SHINHWA TECH CO.,LTD  
TEL : 031-451-9441 FAX : 031-451-9444

0.0±	SCALE:	TITLE:	PART NO:
0.00±	UNIT: MM	1.27MM Pin Header Single Row Right Angle Double Base	APP BY:
0.000±		MATL: PA6T + 30% GF	CHK BY:
		DWG. NO. HA06	DR BY: